

REVISION HISTORY				
REV	DATE	DESCRIPTION	ECO	BY
A	10/20/02	PRODUCTION RELEASE	11956	AK

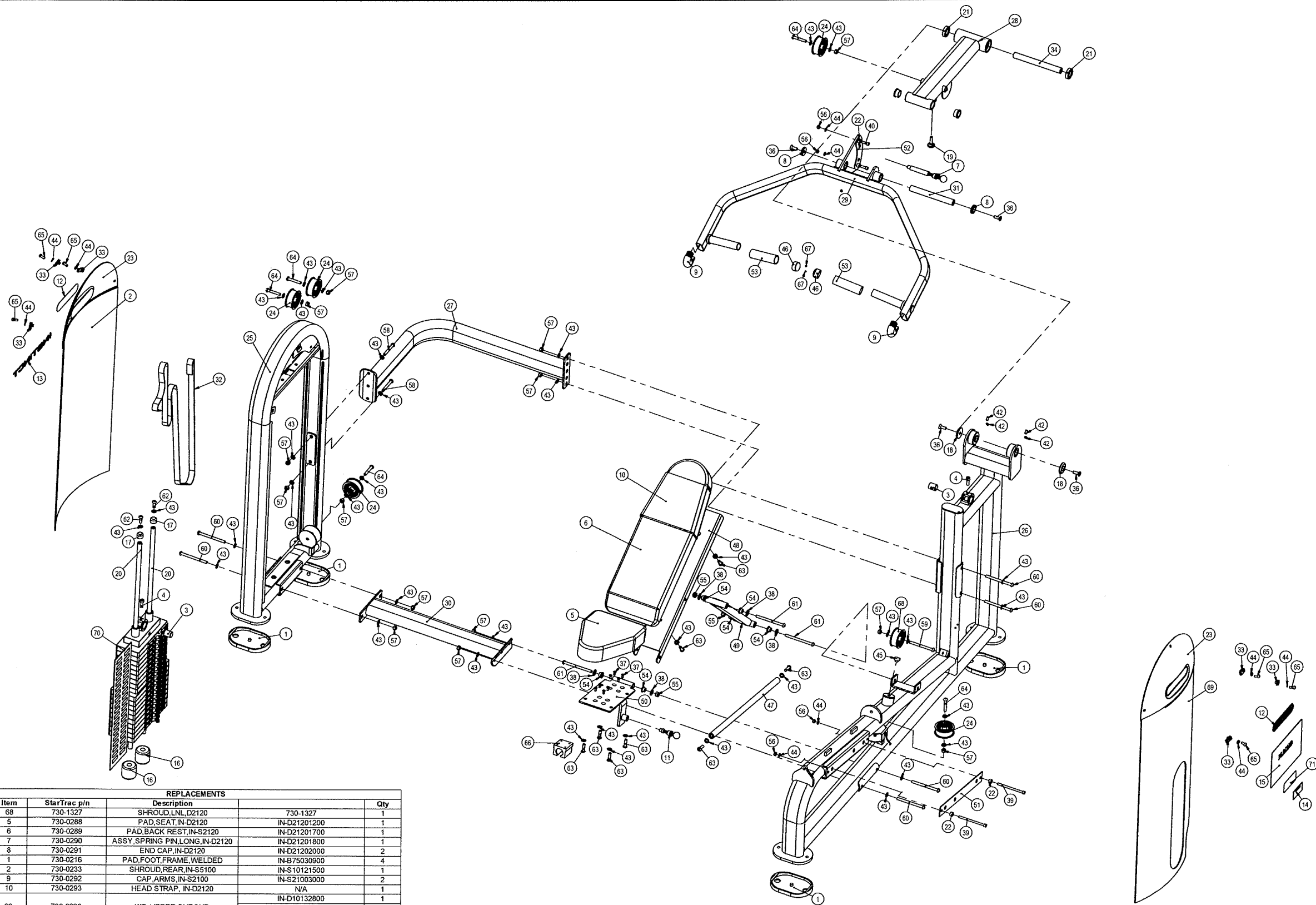

ITEM NO.	STARTRAC PIN	INRAY PIN	DESCRIPTION	QTY
1	730-0216	IN-B75030900	PAD FOOT FRAME WELDED	4
2	730-0233	IN-S10121500	SHROUD REAR IN-S5100	1
3	730-0236	IN-S10121700	PIN, BELT ANCHOR	2
4	730-0237	GB70M10-30A2-70NLL	SCREW, M10x30, SHS, SS	2
5	730-0288	IN-D21201200	PAD, SEAT, IN-D2120	1
6	730-0289	IN-D21201700	PAD, BACK REST, IN-S2120	1
7	730-0290	IN-D21201800	LEVERAGE ARM, ADJUSTMENT, PULL KNOB	1
8	730-0291	IN-D21202000	END CAP, IN-D2120	2
9	730-0292	IN-S21003000	CAP, ARMS, IN-S2100	2
10	730-0293	730-0293	HEAD STRAP, IN-D2120	1
11	730-0316	IN-D21201900	ASSY, SPRING PIN, IN-2120	1
12	730-0383	STARTRAC1	LOGO, STARTRAC	2
13	730-0384	Instinct	LOGO, INSTINCT	1
14	730-0385	CAUTION	LABEL, CAUTION, PINCH POINT	1
15	730-0395	TZ3SD2120	PLACARD, INSTRUCTION, IN-2120	1
16	730-0562	IN-D10132900	BUMPER STACK 60MM	2
17	730-0565	IT80129500	CAP, END, HANDLE	2
18	730-0656	IN-S51102100	CAP, 50MM OD	2
19	730-0660	B5010300	BUMPER, LEVERAGE ARM, STOPPER	1
20	730-0662	IN-S21001300	WEIGHT STACK GUIDE RAIL	2
21	730-0673	GB2766005-22	ISO 15 RBB - 1025 - 14, S.I.N.C. 14, 68	2
22	730-0679	IN-S10111200	STOPPER, IN-S1011	4
23	730-0702	IN-D10132800	SHROUD, UPPER	2
24	730-0721	IN-S51101000	PULLEY, 75MM	5
25	730-0724	IN-D21200100	WEIGHT STACK, FRAME	1
26	730-0725	IN-D21200200	ASSY, MAIN FRAME	1
27	730-0726	IN-D21200300	CROSSBEAM, UPPER FRAME	1
28	730-0727	IN-D21200500	LEVERAGE ARM, PIVOT TUBE	1
29	730-0728	IN-D21200600	LEVERAGE ARM, U-SHAPE HANDLE	1
30	730-0731	IN-D21201400	CROSSBEAM, LOWER FRAME	1
31	730-0732	IN-D21201500	PIVOT SHAFT, M25X213	1
32	730-0778	IN-S10112000	BELT	1
33	730-0845	IN-S21004800	SHROUD, MOUNTING, U-STYLE CLIP	6
34	730-0846	IN-S3200800	SHAFT, 25MM X 234	1
35	730-0858	M25020000	BUSHING, 1.0, BRONZE	2
36	730-0871	CNLM10-30A2-70	SCREW, M10X30, FHM, HK, SS	4
37	730-0873	CNLM8-16A2-70	SCREW, M8X16, FHM, HK, SS	8
38	730-0876	DC12A2-70	WASHER, M12, FENDER, SS	6
39	730-0888	GB70M8-125A2-70	SCREW, M8X125, SHS, SS	2
40	730-0890	GB70M8-25A2-70	SCREW, M8X25, SHS, SS	2
41	730-0895	GB77M8-6A2-70	SCREW, M8X6, SET, SS	2
42	730-0896	GB77M8-16A2-70	SCREW, M8X16, SET, SS	4
43	730-0908	GB9510A2-70	WASHER, M10, FLAT, SS	38
44	730-0910	GB958A2-70	WASHER, M8, BELLEVILLE, SS	10
45	730-0913	HF3574000	BUMPER	1
46	730-0960	IN-B75021300	CAP, HANDLE, GRIP, 33MM	2
47	730-0992	IN-D21200400	ASSY, SEAT GUIDE RAIL	1
48	730-0993	IN-D21200700	BACK PAD SUPPORT BRACKET	1
49	730-0994	IN-D21200800	BACK SUPPORT PIVOT TUBE	1
50	730-0995	IN-D21201000	PLATE, SUPPORT SEAT/PULL KNOB	1
51	730-0996	IN-D21201100	PLATE, M50X405	1
52	730-0997	IN-D21201300	STOP, ROM, IN-S2120	1
53	730-0998	IN-D21201600	LEVERAGE	1
54	730-1059	M01402000	ARM HANDLE, RUBBER, GRIP, SL FEEVE	2
55	730-1102	NM12A2-70	BUSHING, 12MM ID, 13MM	3
56	730-1103	NM8A2-70	NYLOC SELF LOCKING NUT, ST, STL, A2 ISO	6
57	730-1104	NM10A2-70	NUT, M8, NYLON PATCH, SS	4
58	730-1109	PNLM10-80A2-70	NUT, M10, NYLON PATCH, SS	14
59	730-1110	PNLM10-115A2-70	SCREW, M10X115, BHC, SS	2
60	730-1112	PNLM10-130A2-70	SCREW, M10X130, BH, SS	6
61	730-1114	PNLM10-135A2-70	SCREW, M10X135, BH, SS	3
62	730-1118	PNLM10-30A2-70	SCREW, M10, BHC, HK, SS	2
63	730-1119	PNLM10-35A2-70	SCREW, M10X35, BH, SS	8
64	730-1122	PNLM10-63A2-70	SCREW, M10X63, BHC, SS	5
65	730-1138	PNLM8-20A2-70	SCREW, M8X20, BHC, SS	6
66	730-1152	SHO25UJ	SEAT GUIDE BRACKET	2
67	730-1155	YZGB710-30x3 ZDS2	SCREW, 10-30x3, 2, SET	4
68	730-1160	IMEX051800	PULLEY, 75MM	1
69	730-1327	730-1327	SHROUD, LNL, D2120	1
70	730-1401	730-1401	WSA-LNL, 225B, 19H	1
71	730-1491	730-1491	LABEL, INSTRUCTIONS, LOCK N LOAD	1

Item	StarTrac p/n	Description	Qty
68	730-1327	SHROUD, LNL, D2120	1
5	730-0288	PAD, SEAT, IN-D2120	1
6	730-0289	PAD, BACK REST, IN-S2120	1
7	730-0290	ASSY, SPRING PIN, LONG, IN-D2120	1
8	730-0291	END CAP, IN-D2120	2
1	730-0216	PAD, FOOT FRAME, WELDED	4
2	730-0233	SHROUD, REAR, IN-S5100	1
9	730-0292	CAP, ARMS, IN-S2100	2
10	730-0293	HEAD STRAP, IN-D2120	1
23	730-0228	KIT, UPPER SHROUD	1
24	730-0229	KIT, PULLEY REPLACEMENT, 76 MM, SINGLE	1
46	730-0156	ASSY, ENDCAP, 32MM, ALUMINUM	2
52	730-0294	KIT, ADJUSTMENT PLATE, IN-D2120	1
N/A	730-0173	KIT, HARDWARE, IN-D2020	n/a
	730-0215	KIT, BELT REPLACEMENT	15.5 FT

PRODUCTION RELEASE DOCUMENT STATUS

CLASS OF WORK	TOLERANCES FOR MEASURE OF LENGTH ARE						
	0.5	1	2	3	5	10	20
FINE	±0.05	±0.05	±0.1	±0.15	±0.2	±0.3	±0.5
MEDIUM	±0.1	±0.1	±0.2	±0.3	±0.5	±1.2	±2
COARSE	±0.2	±0.3	±0.5	±0.8	±1.2	±3	±4
VERY COARSE	---	±0.5	±1	±1.5	±2.5	±4	±8

MATERIAL	
SEE BOM	

UNISEN, INC. DBA		14410 Myford Road	
STARTRAC		Irvine CA 92606	
DRAWN	AK	DATE	10/12/02
CHECKED	AK	REV	91L-D2120-13BSS
APPROVED	AK	TITLE	IN, DSS, MULTI-PRESS, 0-80, LNL
U.O.M.	MM	SCALE	1:25
PIN	N/A	SHEET	1 OF 1
		SHEET SIZE	B